







PLAN DE SITUATIE

LEGENDA:

LIMITE:
 LIMITE CADASTRALE DE PROPRIETATE

ZONIFICARE:

-  CAI DE CIRCULATIE RUTIERA
-  TROTUARE SI PLATFORME BETONATE
-  PLATFORME BALASTATE
-  ZONE VERZI
-  CONSTRUCTII EXISTENTE
-  CONSTRUCTII PROPUSE - Sala de Sport
-  TEREN SINTETIC PROPUS

Generalitati:

Teren de sport sintetic, inchis perimetral cu gard din plasa de sarma;
 Sistem de iluminat (Nocturna)
 Stadiu sala Sport:
 Structura metalica;
 Fundatii Izolate;
 Inchideri perimetrare din panou termoizolant;
 Invelitoare tip sarpantra cu invelitoare panou termoizolant.

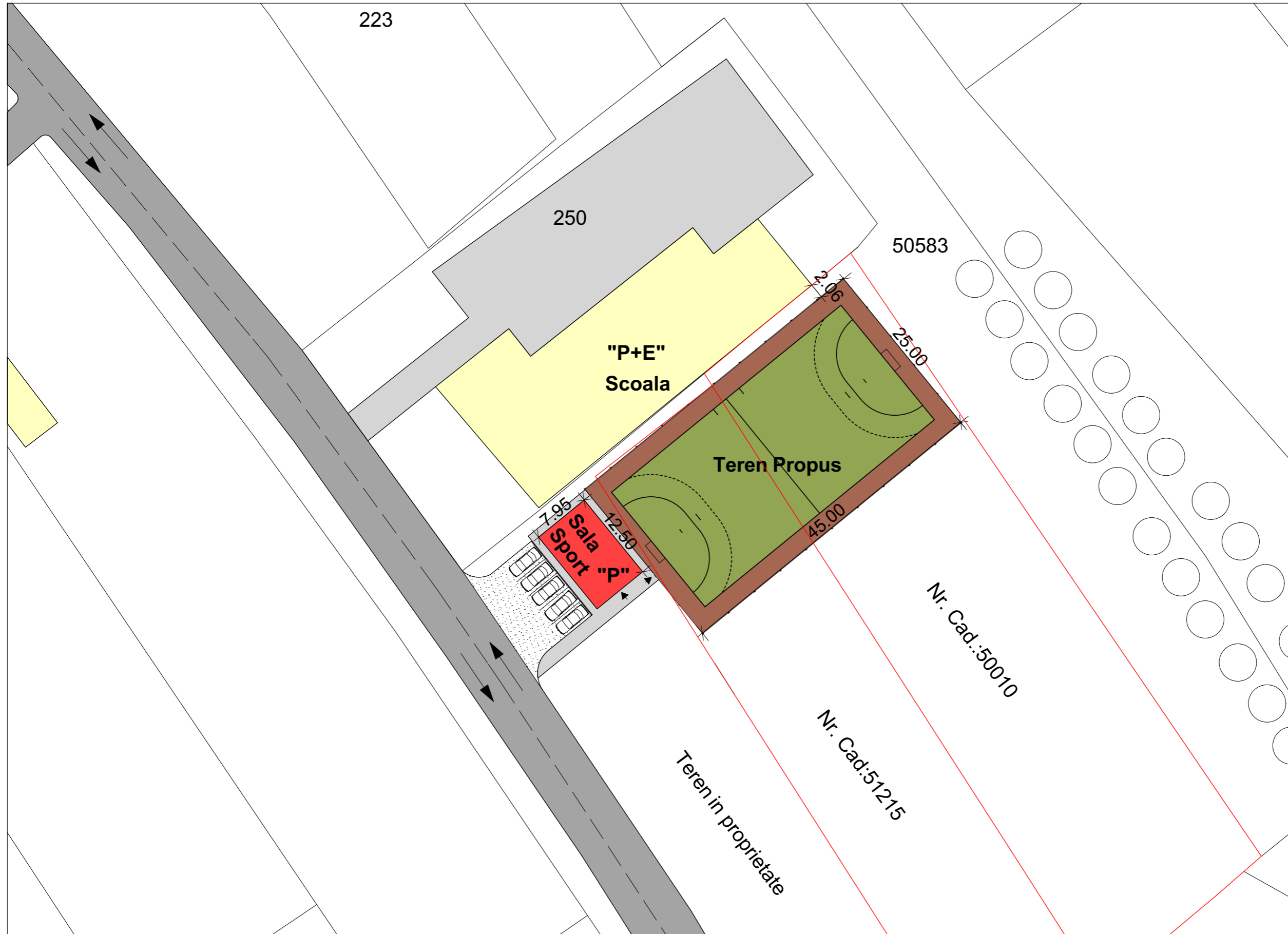

Verificator/Expert		Cerinta:	REFERAT/EXPERTIZA/ NR. DATA
BÂTE MARIAN - BIROU INDIVIDUAL DE ARHITECTURA Codul de Inregistrare Fiscala (C.I.F.): 29995264		Beneficiar:	Proiect nr. 41/2018
Jud. Bihor, Mun. Oradea, Str. Aleea Calinului, Nr.12, Bl. X7, Sc.A, et.4, Ap.17 Telefon: 0740/190.942. Email: bt_marian@yahoo.com		Amplasament:	Faza: D.T.A.C.
Şef proiect	arh. BÂTE MARIAN	Scara: 1:500	Titlu plansa: Plan de Situatie
Proiectat	arh. BÂTE MARIAN		
Desenat	arh. BÂTE MARIAN		
		10/2018	Volum I: -arhitectura- Plansa: 2/A